



November 30, 2020

Dear Everett Public Schools' families,

We hope you all had a restful and safe Thanksgiving holiday. We have a brief update for stage 2 Learning Model Status which brings developmental Pre-K, Developmental Kindergarten, Life Skills and STRIVE students back into the school buildings. The [November 10 communication](#) committed we would provide an update on November 30. At this time the return for these students is still pending. The district will continue to update you as dates become final.

We also have three important family technology updates to share.

Teaching remotely this year has revealed the need to have students update/change their login passwords and to add a layer of security within the district's synchronous instruction through use of Zoom external authentication.

Updating Student Password

We ask that our elementary families please help assist their students in changing their district password. Instructions can be found on the district's website or [here](#).

Information for updating passwords for middle and high school students from home will be coming soon.

Zoom External Authentication

External authentication is a security setting that teachers can choose to use to ensure only their students are in their class Zoom meetings. Starting December 2, students in classes with teachers who utilize external authentication will be asked to enter their ID# @apps.everettsd.org and their password to join the Zoom meeting.

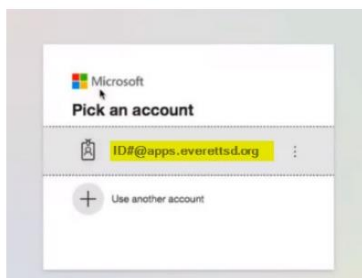

In addition to technology safety actions, the annual updates to your student's information will be online this year, unlike in years past when families received a hardcopy school questionnaire packet at the beginning of school.

Annual Updates Online access in Home Access Center (HAC)

Each year there is a window of time where families are asked to complete an annual update to their children's information. That window is typically in the first two months of school, but

since the 2020-21 school year has been remote learning, this process will be offered online for the first time beginning December 2, 2020 through February 19, 2021.

Please complete the annual update for each of your students starting December 2.

The information requested varies depending on each child's grade level including:

- Contact information for student, guardians and emergency contacts
- Priority setting of contacts
- Health and transportation updates
- Agreements, document updates, etc.

More information about the Annual Update can be found linked under Enrollment on the district webpage or [here](#).

Thank you all so much for your continued partnership and support.

Everett Public Schools Communications